



AN ISO 9001 : 2015 COMPANY







TERMINAL BLOCK

FTC terminal block is a component with an insulated frame that has purpose of securing two or more wires together.

Terminal blocks are classified based on characteristics such as structure, device type, and termination options.

TERMINAL BLOCK CONNECTION METHODS

- Screw-in copper alloy clamp
- Screw-in steel clamp
- Bus Bar termination
- Disconnecting type
- Fuse terminal block
- Stud and nut clamp
- Plugable
- Strip Type

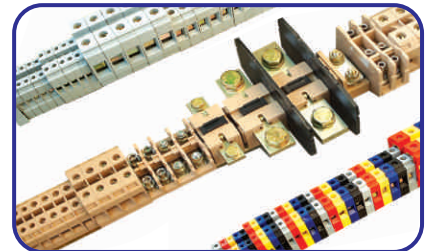

TERMINAL BLOCK TYPES

- Polyamide Terminals
- Melamine Terminals
- PBT Terminals

Terminal Block mounting method is by attachment to a DIN Rail 32, DIN Rail 35, Base mount.

TERMINAL BLOCK IN COPPER ALLOY CLAMP

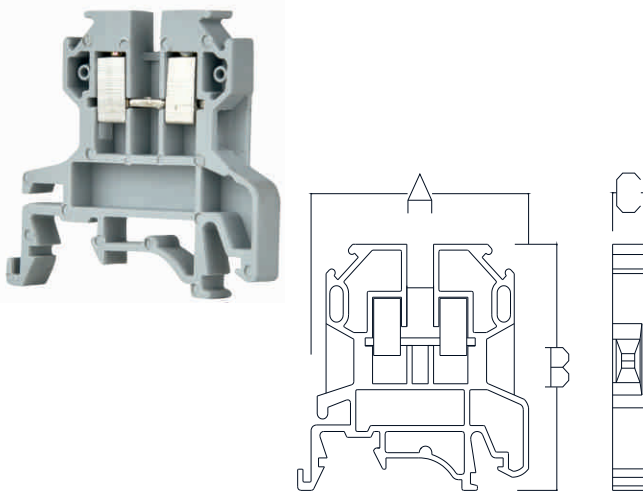

DIMENSIONS & WEIGHT

HEIGHT / B (mm)	37	42
HEIGHT / B (inches)	1.46	1.66
WIDTH / A (mm)	40	42.5
WIDTH / A (inches)	1.57	1.67
THICKNESS / C (mm)	5	6
WEIGHT FOR STANDARD PACKING(KG)	0.60	0.80

MATERIAL DATA

HOUSING	PA 6.6	PA 6.6
STANDARD COLOUR	Grey	Grey
OTHER COLOUR VARIANTS	Red, Yellow, Blue, Black, Green	Red, Yellow, Blue, Black, Green

RATED CONDUCTOR SIZE

STANDARD WIRE - MIN (Sq. mm)	0.5	0.5
STANDARD WIRE - Max (Sq. mm)	1.5	2.5
SOLID WIRE - MIN (Sq. mm)	0.5	0.5
SOLID WIRE - MAX (Sq. mm)	1.5	2.5

RATINGS

RATED VOLTAGE	1000	1000
RATED CURRENT	16	24
RATED CROSS SECTION	0.5	0.5
SHORT TIME WITHSTAND CURRENT (ka)	0.30	0.30
RATED IMPULSE WITHSTAND VOLTAGE (KV)	8	8
POLLUTION DEGREE	III	III

ACCESSORIES

SUITABLE END-PLATE	EP - 1.5PB	EP - 2.5P
SUITABLE SHORTING LINK	PSL - 1.5	PSL - 2.5

GENERAL DATA

TYPE	FTS 1.5PB	FTS 2.5PB
WIRE TERMINATION TECHNOLOGY	SCREW CLAMP	SCREW CLAMP
VOLT	1000	1000
CURRENT	16A	24A
WIRE SIZE	1.5 Sq. mm	2.5 Sq. mm
TORQUE	0.5 Nm	0.5 Nm
STANDARD PACKING QTY (NOS)	100	100



TERMINAL BLOCK

in steel clamp...

TERMINAL BLOCK IN STEEL CLAMP

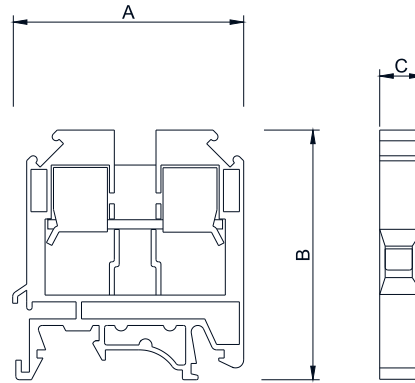

GENERAL DATA

TYPE	FTS 2.5P	FTS 4P	FTS 6P	FTS 10P	FTS 16P	FTS 25P	FTS 35P
WIRE TERMINATION TECHNOLOGY	SCREW CLAMP	SCREW CLAMP	SCREW CLAMP	SCREW CLAMP	SCREW CLAMP	SCREW CLAMP	SCREW CLAMP
VOLT	1000	1000	1000	1000	1000	1000	1000
CURRENT	24A	32A	41A	57A	76 A	101 A	125 A
WIRE SIZE	2.5 Sq. mm	4 Sq. mm	6 Sq. mm	10 Sq. mm	16 Sq. mm	25 Sq. mm	35 Sq. mm
TORQUE	0.5 Nm	0.5 Nm	0.8 Nm	1.2 Nm	1.2 Nm	2.3 Nm	3 Nm
STANDARD PACKING QTY (NOS)	100	100	100	100	100	50	20

DIMENSIONS & WEIGHT

HEIGHT / B (mm)	41	46	46	46	46	50	58
HEIGHT / B (inches)	1.60	1.83	1.83	1.83	1.83	1.96	2.28
WIDTH / A (mm)	42.5	43	43	43	43	43	50.5
WIDTH / A (inches)	1.67	1.67	1.67	1.67	1.67	1.67	1.99
THICKNESS / C (mm)	6.7	6.7	8.0	10	11	11	15
WEIGHT FOR STANDARD PACKING(KG)	0.88	1.27	1.50	2.20	2.80	1.8	1.2

MATERIAL DATA

HOUSING	PA 6.6	PA 6.6	PA 6.6	PA 6.6	PA 6.6	PA 6.6	PA 6.6
STANDARD COLOUR	●	●	●	●	●	●	●
OTHER COLOUR VARIANTS	●●●●●	●●●●●	●●●●●	●●●●●	●●●●●	●●●●●	●●●●●

RATED CONDUCTOR SIZE

STANDARD WIRE - MIN (Sq. mm)	0.5	0.5	0.5	0.5	6	6	10
STANDARD WIRE - Max (Sq. mm)	2.5	4.0	6	10	16	25	35
SOLID WIRE - MIN (Sq. mm)	0.5	0.5	0.5	0.5	6	6	10
SOLID WIRE - MAX (Sq. mm)	2.5	4.0	6.0	10	16	25	35

RATINGS

RATED VOLTAGE	1000	1000	1000	1000	1000	1000	1000
RATED CURRENT	24	32	41	57	76	101	125
RATED CROSS SECTION	0.5	0.5	0.5	1.5	6	6	10
SHORT TIME WITHSTAND CURRENT (ka)	0.30	0.48	0.72	1.2	1.92	3	4.2
RATED IMPULSE WITHSTAND VOLTAGE (KV)	8	8	8	8	8	8	8
POLLUTION DEGREE	III	III	III	III	III	III	III

ACCESSORIES

SUITABLE END-PLATE	EP-2.5P	EP-4-10P	EP-4-10P	EP-4-10P	EP-16-25P	EP-16-25P	EP-35P
SUITABLE SHORTING LINK	PSL-2.5	PSL-4	PSL-6	PSL-10	PSL-16	PSL-25	PSL-35



TERMINAL BLOCK

in steel clamp...

TERMINAL BLOCK IN STEEL CLAMP

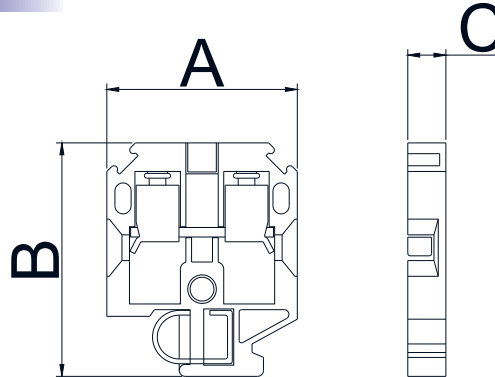
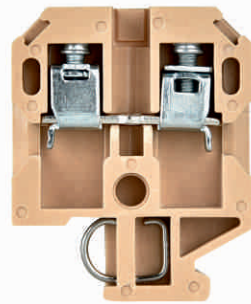

GENERAL DATA

TYPE	FTS 2.5/4	FTS 6	FTS 10	FTS 16	FTS 25	FTS 35
WIRE TERMINATION TECHNOLOGY	SCREW CLAMP	SCREW CLAMP	SCREW CLAMP	SCREW CLAMP	SCREW CLAMP	SCREW CLAMP
VOLT	1000	1000	1000	1000	1000	1000
CURRENT	32A	41A	57A	76A	101 A	125A
WIRE SIZE	4 Sq. mm	6 Sq. mm	10 Sq. mm	16 Sq. mm	25 Sq. mm	35 Sq. mm
TORQUE	0.5 Nm	0.8 Nm	1.2 Nm	1.2 Nm	2.3 Nm	3 Nm
STANDARD PACKING QTY (NOS)	100	100	100	50	50	20

DIMENSIONS & WEIGHT

HEIGHT / B (mm)	49	49	49	55	55	60
HEIGHT / B (inches)	1.93	1.93	1.93	2.17	2.17	2.36
WIDTH / A (mm)	40	40	40	50	50	55
WIDTH / A (inches)	1.57	1.57	1.57	1.97	1.97	2.17
THICKNESS / C (mm)	7	8.0	10	12	12	17.5
WEIGHT FOR STANDARD PACKING(KG)	1.27	1.50	2.20	1.4	1.8	1.2

MATERIAL DATA

HOUSING	MELAMINE	MELAMINE	MELAMINE	MELAMINE	MELAMINE	MELAMINE
STANDARD COLOUR	KHAKI	KHAKI	KHAKI	KHAKI	KHAKI	KHAKI

RATED CONDUCTOR SIZE

STANDARD WIRE - MIN (Sq. mm)	0.5	0.5	0.5	6	6	10
STANDARD WIRE - Max (Sq. mm)	4.0	6.0	10	16	25	35
SOLID WIRE - MIN (Sq. mm)	0.5	0.5	0.5	6	6	10
SOLID WIRE - MAX (Sq. mm)	4.0	10	16	25	25	35

RATINGS

RATED VOLTAGE	1000	1000	1000	1000	1000	1000
RATED CURRENT	32	41	57	76	101	125
RATED CROSS SECTION	0.5	0.5	1.5	6	6	10
SHORT TIME WITHSTAND CURRENT (ka)	0.48	0.72	1.2	1.92	3	4.2
RATED IMPULSE WITHSTAND VOLTAGE (KV)	8	8	8	8	8	8
POLLUTION DEGREE	III	III	III	III	III	III

ACCESSORIES

SUITABLE END-PLATE	EP-2.5-10	EP-2.5-10	EP-2.5-10	EP-16-25	EP-16-25	EP-35
SUITABLE SHORTING LINK	PSL-4	PSL-6	PSL-10	PSL-16	PSL-25	PSL-35



TERMINAL BLOCK

busbar termination...

TERMINAL BLOCK IN BUSBAR TERMINATION

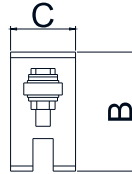
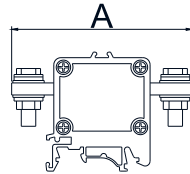

DIMENSION
FTS 50LP, FTS70LP, FTS 95LP

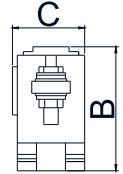
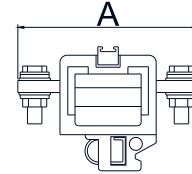
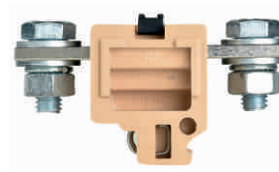

DIMENSION
FTS 50L, FTS70L, FTS 95L

GENERAL DATA

TYPE	FTS 50LP	FTS 70LP	FTS 95LP	FTS 50L	FTS 70L	FTS 95L
WIRE TERMINATION TECHNOLOGY	Nut Bolt Connection	Nut Bolt Connection	Nut Bolt Connection	Nut Bolt Connection	Nut Bolt Connection	Nut Bolt Connection
VOLT	1000	1000	1000	1000	1000	1000
CURRENT	150A	192	270	150	192	270A
WIRE SIZE	50 sq mm	70 sq mm	120 sq mm	50 sq mm	70 Sq mm	120 sq mm
TORQUE	3 Nm	3 Nm	6 Nm	3 Nm	3 Nm	6 Nm
STANDARD PACKING QTY (NOS)	10	10	10	10	10	10

DIMENSIONS & WEIGHT

HEIGHT / B (mm)	49	49	49	51.5	51.5	51.5
HEIGHT / B (inches)	1.93	1.93	1.93	2.03	2.03	2.03
WIDTH / A (mm)	75	93	115	75	93	115
WIDTH / A (inches)	2.95	3.66	4.53	2.95	3.66	4.53
THICKNESS / C (mm)	27	39	39	30	40.5	40.5
WEIGHT FOR STANDARD PACKING(KG)	0.90	1.25	1.64	0.90	1.25	1.64

MATERIAL DATA

HOUSING	PA 6.6	PA 6.6	PA 6.6	MELAMINE	MELAMINE	MELAMINE
STANDARD COLOUR	●	●	●	KHAKHI	KHAKHI	KHAKHI
OTHER COLOUR VARIENTS	● ● ● ● ●	● ● ● ● ●	● ● ● ● ●	----	----	----

RATED CONDUCTOR SIZE

STANDARD WIRE - MIN (Sq. mm)	10	10	10	10	10	10
STANDARD WIRE - Max (Sq. mm)	50	70	50	50	70	50
SOLID WIRE - MIN (Sq. mm)	10	10	10	10	10	10
SOLID WIRE - MAX (Sq. mm)	50	70	50	50	70	50

RATINGS

RATED VOLTAGE	1000	1000	1000	1000	1000	1000
RATED CURRENT	150	192	150	150	192	150
RATED CROSS SECTION	50	70	50	50	70	50
SHORT TIME WITHSTAND CURRENT (ka)	6	8.40	6	6	8.40	6
RATED IMPULSE WITHSTAND VOLTAGE (KV)	12	12	12	12	12	12
POLLUTION DEGREE	III	III	III	III	III	III

ACCESSORIES

SUITABLE END-PLATE	EP-50-95LP	EP-50-95LP	EP-50-95LP	EP-50-95L	EP-50-95L	EP-50-95L
--------------------	------------	------------	------------	-----------	-----------	-----------



TERMINAL BLOCK

disconnecting type...

TERMINAL BLOCK DISCONNECTING

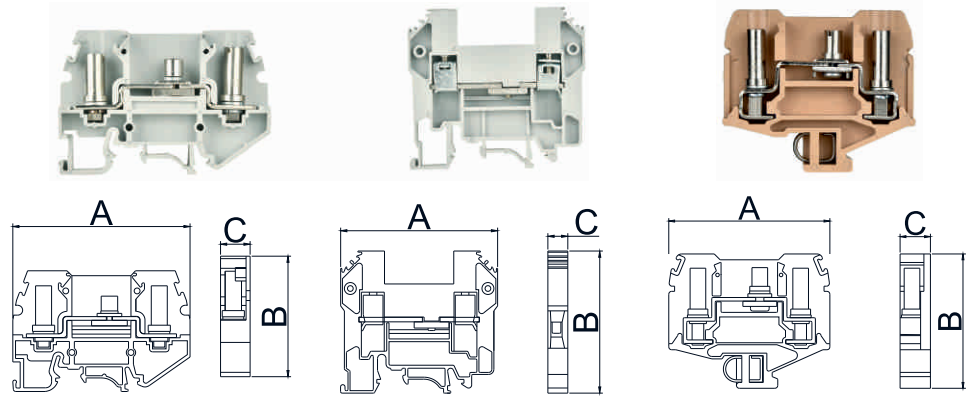

GENERAL DATA

TYPE	FDTP-M4	FDTP	FDTS
WIRE TERMINATION TECHNOLOGY	STUD TYPE	SCREW CLAMP	STUD TYPE
VOLT	1000	1000	1000
CURRENT	41	41	41
WIRE SIZE	6 Sq mm	6 Sq mm	6 Sq mm
TORQUE	1.4 Nm	1.4 Nm	1.4 Nm
STANDARD PACKING QTY (NOS)	40	40	40

DIMENSIONS & WEIGHT

HEIGHT / B (mm)	49	57	57
HEIGHT / B (inches)	1.93	2.24	2.24
WIDTH / A (mm)	72	63	69
WIDTH / A (inches)	2.83	2.48	2.72
THICKNESS / C (mm)	12	8.5	13
WEIGHT FOR STANDARD PACKING(KG)	1.5	1.3	1.2

MATERIAL DATA

HOUSING	PA 6.6	PA 6.6	MELAMINE
STANDARD COLOUR	●	●	KHAKI
OTHER COLOUR VARIANTS	● ● ● ● ●	● ● ● ● ●	-----

RATED CONDUCTOR SIZE

STANDARD WIRE - MIN (Sq. mm)	0.5	0.5	0.5
STANDARD WIRE - Max (Sq. mm)	6	6	6
SOLID WIRE - MIN (Sq. mm)	0.5	0.5	0.5
SOLID WIRE - MAX (Sq. mm)	6	6	6

RATINGS

RATED VOLTAGE	1000	1000	1000
RATED CURRENT	41	41	41
RATED CROSS SECTION	6	6	6
SHORT TIME WITHSTAND CURRENT (ka)	0.72	0.72	0.72
RATED IMPULSE WITHSTAND VOLTAGE (KV)	8	8	8
POLLUTION DEGREE	III	III	III



TERMINAL BLOCK

with fuse...

FUSE TERMINAL BLOCK

WITHOUT FUSE BLOW OFF INDICATOR

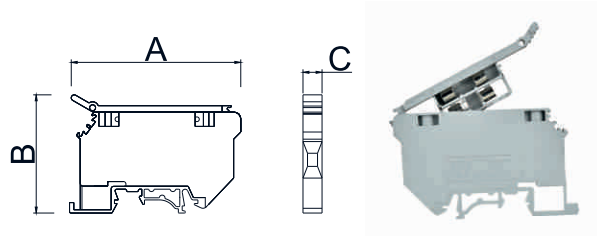

WITH FUSE BLOW OFF INDICATOR

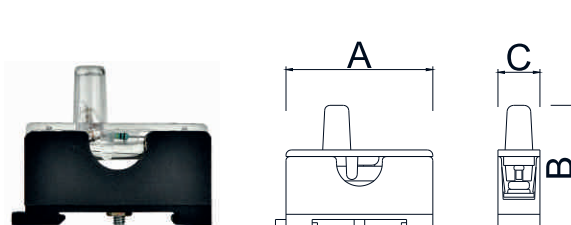

GENERAL DATA

TYPE	FTS FL 4P
WIRE TERMINATION TECHNOLOGY	SCREW CLAMP
VOLT	1000
CURRENT	6.3 A
WIRE SIZE	4 Sq mm
TORQUE	0.4 Nm
STANDARD FUSE RATING	4 A
STANDARD PACKING QTY (NOS)	50

DIMENSIONS & WEIGHT

HEIGHT / B (mm)	50
HEIGHT / B (inches)	1.97
WIDTH / A (mm)	72
WIDTH / A (inches)	2.83
THICKNESS / C (mm)	8
GLASS FUSE SIZE (mm)	5X20
WEIGHT FOR STANDARD PACKING(KG)	0.70

MATERIAL DATA

HOUSING	PA 6.6
STANDARD COLOUR	Grey
OTHER COLOUR VARIANTS	Red, Yellow, Blue, Black, Green

RATED CONDUCTOR SIZE

STANDARD WIRE - MIN (Sq. mm)	0.5
STANDARD WIRE - Max (Sq. mm)	4
SOLID WIRE - MIN (Sq. mm)	0.5
SOLID WIRE - MAX (Sq. mm)	4

RATINGS

RATED VOLTAGE	1000
RATED CURRENT	6.3
RATED CROSS SECTION	4
SHORT TIME WITHSTAND CURRENT (ka)	0.48
RATED IMPULSE WITHSTAND VOLTAGE (KV)	8
POLLUTION DEGREE	III

GENERAL DATA

TYPE	FTS FL 10P
WIRE TERMINATION TECHNOLOGY	SCREW CLAMP
VOLT	1000
CURRENT	10 A
WIRE SIZE	4 Sq mm
TORQUE	0.4 Nm
STANDARD FUSE RATING	10 A
STANDARD PACKING QTY (NOS)	10

DIMENSIONS & WEIGHT

HEIGHT / B (mm)	47
HEIGHT / B (inches)	1.85
WIDTH / A (mm)	56
WIDTH / A (inches)	2.20
THICKNESS / C (mm)	16
GLASS FUSE SIZE (mm)	6X30
WEIGHT FOR STANDARD PACKING(KG)	0.30

MATERIAL DATA

HOUSING	PA 6.6
STANDARD COLOUR	BLACK
OTHER COLOUR VARIANTS	----

RATED CONDUCTOR SIZE

STANDARD WIRE - MIN (Sq. mm)	0.5
STANDARD WIRE - Max (Sq. mm)	4
SOLID WIRE - MIN (Sq. mm)	0.5
SOLID WIRE - MAX (Sq. mm)	4

RATINGS

RATED VOLTAGE	1000
RATED CURRENT	10
RATED CROSS SECTION	4
SHORT TIME WITHSTAND CURRENT (ka)	0.48
RATED IMPULSE WITHSTAND VOLTAGE (KV)	8
POLLUTION DEGREE	III



TERMINAL BLOCK

nut type...

TERMINAL BLOCK WITH NUT CONNECTION

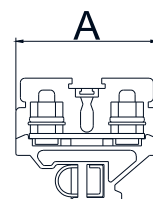
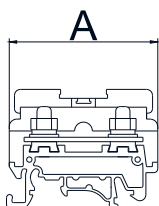

DIMENSION
FSTS N4P, FSTS N5P, FSTS N6P

DIMENSION
FSTS N4, FSTS N5, FSTS N6

GENERAL DATA

TYPE	FSTS N4P	FSTS N5P	FSTS N6P	FSTS N4	FSTS N5	FSTS N6
WIRE TERMINATION TECHNOLOGY	Nut Driver Operated	Nut Driver Operated	Nut Driver Operated	Nut Driver Operated	Nut Driver Operated	Nut Driver Operated
VOLT	1000	1000	1000	1000	1000	1000
CURRENT	57	76	101	57	76	101
WIRE SIZE	10 Sq mm	16 Sq mm	25 Sq mm	10 Sq mm	16 Sq mm	25 Sq mm
TORQUE	1.2 Nm	2 Nm	2.5 Nm	1.2 Nm	2 Nm	2.5 Nm
STANDARD PACKING QTY (NOS)	40	40	40	40	40	40

DIMENSIONS & WEIGHT

HEIGHT / B (mm)	40	40	40	44	44	44
HEIGHT / B (inches)	1.57	1.57	1.57	1.73	1.73	1.73
WIDTH / A (mm)	50	50	50	50	50	50
WIDTH / A (inches)	1.97	1.97	1.97	1.97	1.97	1.97
THICKNESS / C (mm)	17	17	17	17	17	17
WEIGHT FOR STANDARD PACKING(KG)	0.93	1.10	1.65	0.93	1.10	1.65

MATERIAL DATA

HOUSING	PA 6.6	PA 6.6	PA 6.6	MELAMINE	MELAMINE	MELAMINE
STANDARD COLOUR	●	●	●	KHAKI	KHAKI	KHAKI
OTHER COLOUR VARIANTS	● ● ● ● ● ●	● ● ● ● ● ●	● ● ● ● ● ●	----	----	----

RATED CONDUCTOR SIZE

STANDARD WIRE - MIN (Sq. mm)	0.5	0.5	6	0.5	0.5	10
STANDARD WIRE - Max (Sq. mm)	10	16	25	10	16	35
SOLID WIRE - MIN (Sq. mm)	0.5	0.5	6	0.5	0.5	10
SOLID WIRE - MAX (Sq. mm)	10	16	25	10	16	35

RATINGS

RATED VOLTAGE	1000	1000	1000	1000	1000	1000
RATED CURRENT	57	76	101	57	76	101
RATED CROSS SECTION	10	16	25	10	16	25
SHORT TIME WITHSTAND CURRENT (ka)	1.2	1.92	3	1.2	1.92	3
RATED IMPULSE WITHSTAND VOLTAGE (KV)	8	8	8	8	8	8
POLLUTION DEGREE	III	III	III	III	III	III

ACCESSORIES

SUITABLE END-PLATE	EP-N/BP	EP-N/BP	EP-N/BP	EP-N/B	EP-N/B	EP-N/B
--------------------	---------	---------	---------	--------	--------	--------



TERMINAL BLOCK

stud type...

TERMINAL BLOCK WITH STUD CONNECTION

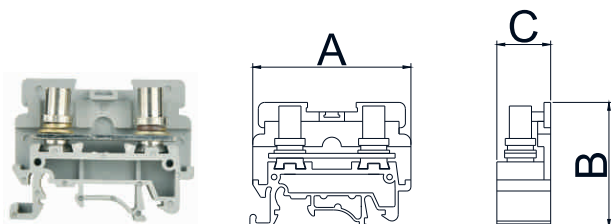

DIMENSION
FSTS B4P, FSTS B5P, FSTS B6P

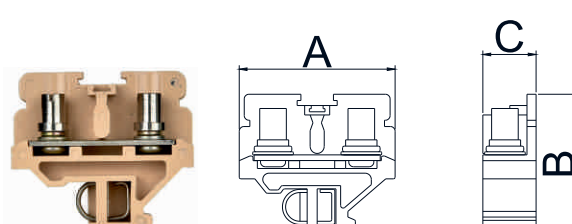

DIMENSION
FSTS B3, FSTS B4, FSTS B5, FSTS B6

GENERAL DATA

TYPE	FSTS B4P	FSTS B5P	FSTS B6P	FSTS B3	FSTS B4	FSTS B5	FSTS B6
WIRE TERMINATION TECHNOLOGY	Stud-Scw Driver Operated	Stud-Scw Driver Operated	Stud-Scw Driver Operated	Stud-Scw Driver Operated	Stud-Scw Driver Operated	Stud-Scw Driver Operated	Stud-Scw Driver Operated
VOLT	1000	1000	1000	1000	1000	1000	1000
CURRENT	57	76	101	32	57	76	101
WIRE SIZE	10 Sq mm	16 Sq mm	25 Sq mm	4 Sq mm	10 Sq mm	16 Sq mm	25 Sq mm
TORQUE	1.2Nm	2 Nm	2.5 Nm	0.5 Nm	1.2 Nm	2 Nm	2.5 Nm
STANDARD PACKING QTY (NOS)	40	40	40	40	40	40	40

DIMENSIONS & WEIGHT

HEIGHT / B (mm)	40	40	40	44	44	44	44
HEIGHT / B (inches)	1.57	1.57	1.57	1.73	1.73	1.73	1.73
WIDTH / A (mm)	50	50	50	50	50	50	50
WIDTH / A (inches)	1.97	1.97	1.97	1.97	1.97	1.97	1.97
THICKNESS / C (mm)	17	17	17	10	13	13	13
WEIGHT FOR STANDARD PACKING(KG)	0.93	1.10	1.65	1.10	0.93	1.10	1.65

MATERIAL DATA

HOUSING	PA 6.6	PA 6.6	PA 6.6	MELAMINE	MELAMINE	MELAMINE	MELAMINE
STANDARD COLOUR	●	●	●	KHAKI	KHAKI	KHAKI	KHAKI
OTHER COLOUR VARIANTS	● ● ● ● ●	● ● ● ● ●	● ● ● ● ●	-----	-----	-----	-----

RATED CONDUCTOR SIZE

STANDARD WIRE - MIN (Sq. mm)	0.5	0.5	6	0.5	0.5	0.5	6
STANDARD WIRE - Max (Sq. mm)	10	16	25	4	10	16	25
SOLID WIRE - MIN (Sq. mm)	0.5	0.5	6	0.5	0.5	0.5	6
SOLID WIRE - MAX (Sq. mm)	10	16	25	4	10	06	25

RATINGS

RATED VOLTAGE	1000	1000	1000	1000	1000	1000	1000
RATED CURRENT	57	76	101	32	57	76	101
RATED CROSS SECTION	10	16	25	4	10	16	6
SHORT TIME WITHSTAND CURRENT (ka)	1.2	1.92	3	0.48	1.2	1.92	3
RATED IMPULSE WITHSTAND VOLTAGE (KV)	8	8	8	8	8	8	8
POLLUTION DEGREE	III	III	III	III	III	III	III

ACCESSORIES

SUITABLE END-PLATE	EP-N-BP	EP-N-BP	EP-N-BP	EP-N-B	EP-N-B	EP-N-B	EP-N-B
--------------------	---------	---------	---------	--------	--------	--------	--------



TERMINAL BLOCK

pluggable...

PLUGABLE TERMINAL BLOCK

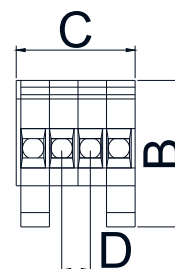
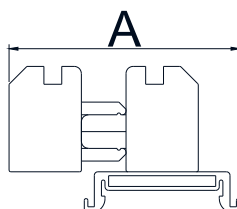
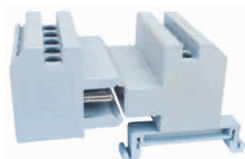

GENERAL DATA

TYPE	PSC 2	PSC 3	PSC 4	PSC 5	PSC 6	PSC 7	PSC 8
WIRE TERMINATION TECHNOLOGY	SCREW CLAMP	SCREW CLAMP	SCREW CLAMP	SCREW CLAMP	SCREW CLAMP	SCREW CLAMP	SCREW CLAMP
VOLT	1000	1000	1000	1000	1000	1000	1000
CURRENT	32	32	32	32	32	32	32
WIRE SIZE	6 Sq mm	6 Sq mm	6 Sq mm	6 Sq mm	6 Sq mm	6 Sq mm	6 Sq mm
TORQUE	0.8 Nm	0.8 Nm	0.8 Nm	0.8 Nm	0.8 Nm	0.8 Nm	0.8 Nm
STANDARD PACKING QTY (NOS)	10	10	10	10	10	10	10

DIMENSIONS

HEIGHT / B (mm)	32	32	32	32	32	32	32
HEIGHT / B (inches)	1.26	1.26	1.26	1.26	1.26	1.26	1.26
WIDTH / A (mm)	59	59	59	59	59	59	59
WIDTH / A (inches)	2.32	2.32	2.32	2.32	2.32	2.32	2.32
THICKNESS / C (mm)	16	24	32	40	48	56	64
PITCH / D (mm)	8	8	8	8	8	8	8

MATERIAL DATA

HOUSING	PA 6.6	PA 6.6	PA 6.6	PA 6.6	PA 6.6	PA 6.6	PA 6.6
STANDARD COLOUR	●	●	●	●	●	●	●
OTHER COLOUR VARIANTS	●●●●●	●●●●●	●●●●●	●●●●●	●●●●●	●●●●●	●●●●●

RATED CONDUCTOR SIZE

STANDARD WIRE - MIN (Sq. mm)	0.5	0.5	0.5	0.5	0.5	0.5	0.5
STANDARD WIRE - Max (Sq. mm)	6	6	6	6	6	6	6
SOLID WIRE - MIN (Sq. mm)	0.5	0.5	0.5	0.5	0.5	0.5	0.5
SOLID WIRE - MAX (Sq. mm)	6	6	6	6	6	6	6

RATINGS

RATED VOLTAGE	1000	1000	1000	1000	1000	1000	1000
RATED CURRENT	32	32	32	32	32	32	32
RATED CROSS SECTION	6	6	6	6	6	6	6
SHORT TIME WITHSTAND CURRENT (ka)	0.72	0.72	0.72	0.72	0.72	0.72	0.72
RATED IMPULSE WITHSTAND VOLTAGE (KV)	8	8	8	8	8	8	8
POLLUTION DEGREE	III	III	III	III	III	III	III



TERMINAL BLOCK

SPECIAL PURPOSE TERMINAL BLOCK

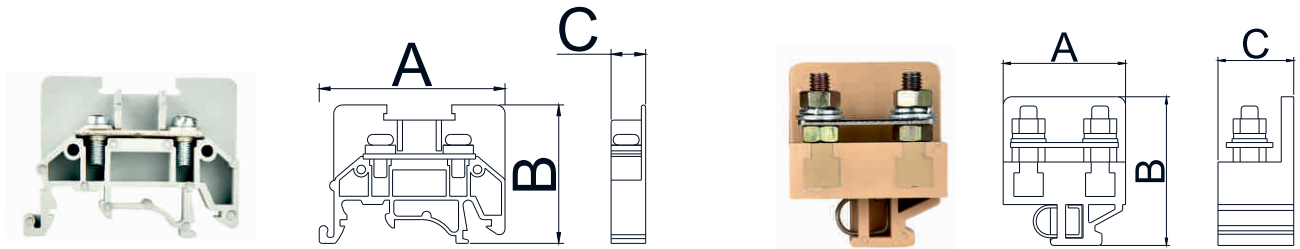

GENERAL DATA

TYPE	FUT 2.5/4P	FUT 6/10P	FSTS RN5	FSTS RN6
WIRE TERMINATION TECHNOLOGY	Screw Clamp	Screw Clamp	Nut Driver Operated	Nut Driver Operated
VOLT	1000	1000	1000	1000
CURRENT	32A	57A	76A	101A
WIRE SIZE	4 Sq. mm	10 Sq. mm	16 Sq. mm	25 Sq. mm
TORQUE	0.5 Nm	1.2 Nm	2 Nm	2.5 Nm
STANDARD PACKING QTY (NOS)	100	100	20	40

DIMENSIONS & WEIGHT

HEIGHT / B (mm)	32	32	51	51
HEIGHT / B (inches)	1.26	1.26	2.00	2.00
WIDTH / A (mm)	43	43	42	42
WIDTH / A (inches)	1.69	1.69	1.65	1.65
THICKNESS / C (mm)	8.5	10	26	17
WEIGHT FOR STANDARD PACKING(KG)	1.27	2.20	1.10	1.65

MATERIAL DATA

HOUSING	PA 6.6	PA 6.6	MELAMINE	MELAMINE
STANDARD COLOUR	●	●	KHAKI	KHAKI
OTHER COLOUR VARIANTS	● ● ● ● ● ●	● ● ● ● ● ●	----	----

RATED CONDUCTOR SIZE

STANDARD WIRE - MIN (Sq. mm)	0.5	0.5	0.5	6
STANDARD WIRE - Max (Sq. mm)	4.0	10.0	16	25
SOLID WIRE - MIN (Sq. mm)	0.5	0.5	0.5	6
SOLID WIRE - MAX (Sq. mm)	4.0	10.0	16	25

RATINGS

RATED VOLTAGE	1000	1000	1000	1000
RATED CURRENT	32	57	76	101
RATED CROSS SECTION	0.5	1.5	16	25
SHORT TIME WITHSTAND CURRENT (ka)	0.48	1.2	1.92	3
RATED IMPULSE WITHSTAND VOLTAGE (KV)	8	8	8	8
POLLUTION DEGREE	III	III	III	III



END PLATE

END PLATES FOR TERMINAL BLOCK

The last terminal in a terminal strip must be closed to prevent possible electrical hazards to close this end plates are used. End plates must also be used with in a terminal strip that make use of terminals of different sizes. This ensure the touch safe requirement is met for live voltage components & that the terminals are touch-safe. These are made of Polyamide material or Melamine material. In case of BusBar Termination End plates also used as phase separator plate between two consecutive terminal.

End Plate can also be used to maintain the required clearance and creepage distance in order to guarantee the rated voltage for the application. this can be used when cross connections are used side-by-side.

External dimension of End Plates matches the dimension of terminal block.



GENERAL DATA

TYPE	SUITABLE FOR TERMINAL BLOCK	POLLUTION DEGREE	STD. PACK.	HOUSING	STD. COLOUR	OTHER COLOUR
EP-1.5PB	FTS-1.5PB	III	100	PA 6.6		
EP-2.5PB	FTS-2.5PB	III	100	PA 6.6		
EP-2.5P	FTS-2.5P	III	100	PA 6.6		
EP-4-10P	FTS-4P, FTS-6P, FTS-10P	III	100	PA 6.6		
EP-16-25P	FTS-16P, FTS-25P	III	100	PA 6.6		
EP-35P	FTS-35P	III	100	PA 6.6		
EP-2.5-10	FTS-2.5/4, FTS-6, FTS-10	III	100	MELAMINE	KHAKI	-
EP-16-25	FTS-16, FTS-25	III	100	MELAMINE	KHAKI	-
EP-35	FTS-35	III	100	MELAMINE	KHAKI	-
EP-N/BP	FSTS-N4P, FSTS-N5P, FSTS-N6P	III	100	PA 6.6		
EP-N/BP	FSTS-B4P, FSTS-B5P, FSTS-B6P	III	100	PA 6.6		
EP-N/B	FSTS-N4, FSTS-N5, FSTS-N6	III	100	MELAMINE	KHAKI	-
EP-N/B	FSTS-B4, FSTS-B5, FSTS-B6	III	100	MELAMINE	KHAKI	-
EP-FDTP-M4	FDTP-M4	III	100	PA 6.6		
EP-FDTP	FDTP	III	100	PA 6.6		
EP-FDTPS	FDTPS	III	100	MELAMINE	KHAKI	-
EP-50-95LP	FTS-50LP, FTS-70LP, FTS-95LP	III	100	PA 6.6		
EP-50-95	FTS-50L, FTS-70L, FTS-95L	III	100	MELAMINE	KHAKI	--



END CLAMP & SHORTING LINK

END CLAMP FOR TERMINAL BLOCK



GENERAL DATA

TYPE	ECP
SUITABLE FOR	DIN32-35 RAIL
POLLUTION DEGREE	III
STANDARD PACKING	50

MATERIAL DATA

HOUSING	PA 6.6
STANDARD COLOUR	●



GENERAL DATA

TYPE	ECP-2
SUITABLE FOR	DIN-35 RAIL
POLLUTION DEGREE	III
STANDARD PACKING	50

MATERIAL DATA

HOUSING	PA 6.6
STANDARD COLOUR	●



GENERAL DATA

TYPE	ECS
SUITABLE FOR	DIN-32 RAIL
STANDARD PACKING	100

MATERIAL DATA

HOUSING	STEEL
---------	-------



GENERAL DATA

TYPE	ECS-2
SUITABLE FOR	DIN-35 RAIL
STANDARD PACKING	100

MATERIAL DATA

HOUSING	STEEL
---------	-------

SHORTING LINKS FOR TERMINAL BLOCK

PERMANENT SHORTING LINK



Permanent Shorting links are used to interconnect two adjacent terminal blocks of 2.5 / 4mm and make switchable cross connection. The links are fitted onto the terminal blocks with long studs and screws. As the links rest above the top surface of the terminal blocks, they can be readily opened up. For a pair of terminal blocks to be shorted, two studs are required. Further, since the links rest above the top surface of the terminal block, it is recommended to mount a barrier plate / partition plate between two adjacent pairs of shorted terminal blocks. Links are available in 2-10 way. Use for centre shorting.

COMB TYPE SHORTING LINK



Comb type Shorting links are used to interconnect two or more terminal blocks of same type and same potential, it is recommended that factory made shorting links which are considering the rated current of the terminal block and its pitch are used for interconnection purpose rather than looping by wire which is not a reliable practice. Links are available in 2-10 way. Use for side ways shorting.

Permanent Shorting Link	PSL-1.5	PSL-2.5	PSL-2.5	PSL-4	PSL-6	PSL-10	PSL-16	PSL-25	PSL-35	PSL-2.5/4	PSL-6	PSL-10	PSL-16	PSL-25	PSL-35
Comb Type Shorting Link	CSL-1.5	CSL-2.5	CSL-2.5	CSL-4	CSL-6	CSL-10	CSL-16	CSL-25	CSL-35	CSL-2.5/4	CSL-6	CSL-10	CSL-16	CSL-25	CSL-35
Suitable For	FTS-1.5PB	FTS-2.5PB	FTS-2.5P	FTS-4P	FTS-6P	FTS-10P	FTS-16P	FTS-25P	FTS-35P	FTS-2.5/4	FTS-6	FTS-10	FTS-16	FTS-25	FTS-35
Pitch	5	6	6.7	6.7	8	10	11	11	15	7	8	10	12	12	17.5



TERMINAL STRIP

strip type ...

STRIP TYPE TERMINAL BLOCK

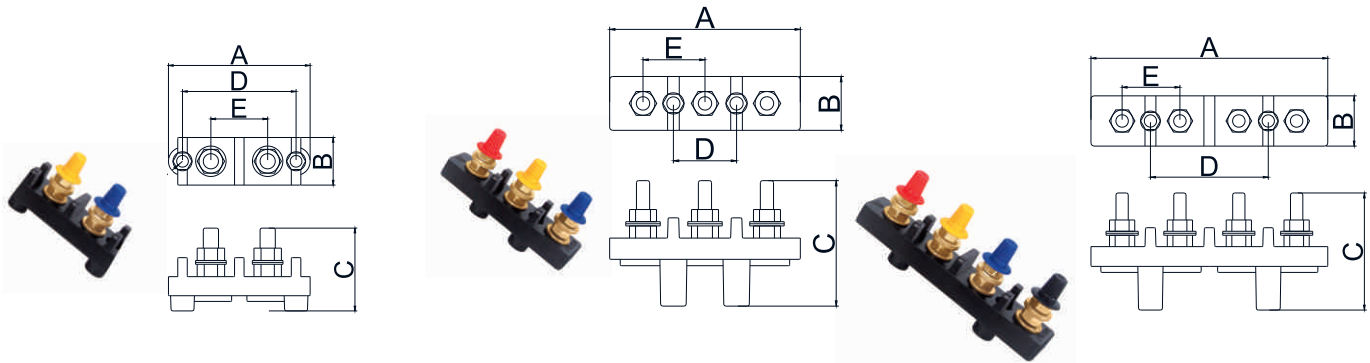

GENERAL DATA

TYPE	DP-63	TP-63	TPN-63
WIRE TERMINATION TECHNOLOGY	NUT DRIVER OPERATED	NUT DRIVER OPERATED	NUT DRIVER OPERATED
VOLT	1000	1000	1000
CURRENT	63	63	63
WIRE SIZE	16 Sq mm	16 Sq mm	16 Sq mm
TORQUE	1.2 Nm	1.2 Nm	1.2 Nm
NO. OF POLE	2	3	4
STANDARD PACKING QTY (NOS)	15	15	15

DIMENSIONS & WEIGHT

WIDTH / A (mm)	75	90	120
THICKNESS / B (mm)	25	25	25
HEIGHT / C (mm)	45	49	49
MOUNTING SIZE / D (mm)	60	29	60
PITCH / E (mm)	30	29	29
WEIGHT FOR STANDARD PACKING(KG)	1.26	1.40	1.90

MATERIAL DATA

HOUSING	PF / DMC MOULDED	PF / DMC MOULDED	PF / DMC MOULDED
STANDARD COLOUR IN PF	●	●	●
STANDARD COLOUR IN DMC	●	●	●

RATED CONDUCTOR SIZE

STANDARD WIRE - MIN (Sq. mm)	0.5	0.5	0.5
STANDARD WIRE - Max (Sq. mm)	16	16	16
SOLID WIRE - MIN (Sq. mm)	0.5	0.5	0.5
SOLID WIRE - MAX (Sq. mm)	25	25	25

RATINGS

RATED VOLTAGE	1000	1000	1000
RATED CURRENT	63	63	63
RATED CROSS SECTION	6	6	6
SHORT TIME WITHSTAND CURRENT (ka)	1.92	1.92	1.92
RATED IMPULSE WITHSTAND VOLTAGE (KV)	8	8	8
POLLUTION DEGREE	III	III	III



TERMINAL STRIP

strip type ...

STRIP TYPE TERMINAL BLOCK

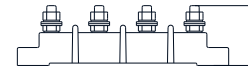
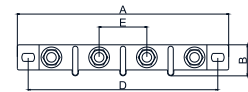
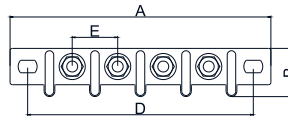
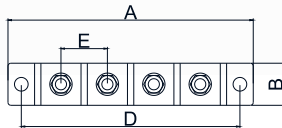

GENERAL DATA

TYPE	TPN-100	TPN-200	TPN-315
WIRE TERMINATION TECHNOLOGY	NUT DRIVER OPERATED	NUT DRIVER OPERATED	NUT DRIVER OPERATED
VOLT	1000	1000	1000
CURRENT	100	200	315
WIRE SIZE	35 Sq mm	70 Sq mm	120 Sq mm
TORQUE	3 Nm	3 Nm	6 Nm
NO. OF POLE	4	4	4
STANDARD PACKING QTY (NOS)	10	4	4

DIMENSIONS & WEIGHT

WIDTH / A (mm)	175	230	265
THICKNESS / B (mm)	30	43	39
HEIGHT / C	42	57	79
SIZE / D (mm)	154	200	235
PITCH / E (mm)	32	40	60
WEIGHT FOR STANDARD PACKING(KG)	2.0	2.2	3.45

MATERIAL DATA

HOUSING	PF / DMC MOULDED	DMC MOULDED	DMC MOULDED
STANDARD COLOUR IN PF	●	----	----
STANDARD COLOUR IN DMC	●	●	●

RATED CONDUCTOR SIZE

STANDARD WIRE - MIN (Sq. mm)	0.5	0.5	0.5
STANDARD WIRE - Max (Sq. mm)	35	70	120
SOLID WIRE - MIN (Sq. mm)	0.5	0.5	0.5
SOLID WIRE - MAX (Sq. mm)	35	70	120

RATINGS

RATED VOLTAGE	1000	1000	1000
RATED CURRENT	100	200	315
RATED CROSS SECTION	6	70	120
SHORT TIME WITHSTAND CURRENT (ka)	3	8.40	6
RATED IMPULSE WITHSTAND VOLTAGE (KV)	8	12	12
POLLUTION DEGREE	III	III	III



TERMINAL STRIP

strip type ...

STRIP TYPE TERMINAL BLOCK

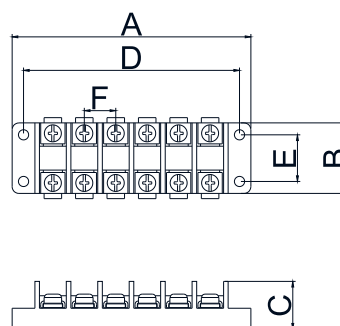

GENERAL DATA

TYPE	TSO-302	TSO-303	TSO-304	TSO-305	TSO-306	TSO-308	TSO-3010	TSO-3012
WIRE TERMINATION TECHNOLOGY	Screw Driver Operated	Screw Driver Operated	Screw Driver Operated	Screw Driver Operated	Screw Driver Operated	Screw Driver Operated	Screw Driver Operated	Screw Driver Operated
No. OF WAYS	2	3	4	5	6	8	10	12
VOLT	500	500	500	500	500	500	500	500
CURRENT	30	30	30	30	30	30	30	30
WIRE SIZE	4 Sq mm	4 Sq mm	4 Sq mm	4 Sq mm	4 Sq mm	4 Sq mm	4 Sq mm	4 Sq mm
TORQUE	0.5Nm	0.5Nm	0.5Nm	0.5Nm	0.5Nm	0.5Nm	0.5Nm	0.5Nm
STANDARD PACKING QTY (NOS)	20	20	20	20	20	20	20	20

DIMENSIONS & WEIGHT

WIDTH / A (mm)	50	-	77.5	91	105	132.5	160	-
THICKNESS / B (mm)	31	31	31	31	31	31	31	31
HEIGHT / C (mm)	21	21	21	21	21	21	21	21
MOUNTING SIZE / D (mm)	40		68	81.5	95	122	149	
MOUNTING SIZE / E (mm)	20.5	20.5	20.5	20.5	20.5	20.5	20.5	20.5
PITCH / F (mm)	14	14	14	14	14	14	14	14
WEIGHT FOR STANDARD PACKING(KG)	0.60		1.00	1.20		1.70	2.20	

MATERIAL DATA

HOUSING	PBT	PBT	PBT	PBT	PBT	PBT	PBT	PBT
STANDARD COLOUR	●	●	●	●	●	●	●	●

RATED CONDUCTOR SIZE

STANDARD WIRE - MIN (Sq. mm)	0.5	0.5	0.5	0.5	0.5	0.5	0.5	0.5
STANDARD WIRE - Max (Sq. mm)	4	4	4	4	4	4	4	4
SOLID WIRE - MIN (Sq. mm)	0.5	0.5	0.5	0.5	0.5	0.5	0.5	0.5
SOLID WIRE - MAX (Sq. mm)	4	4	4	4	4	4	4	4

RATINGS

RATED VOLTAGE	500	500	500	500	500	500	500	500
RATED CURRENT	30	30	30	30	30	30	30	30
RATED CROSS SECTION	0.5	0.5	0.5	0.5	0.5	0.5	0.5	0.5
SHORT TIME WITHSTAND CURRENT (ka)	0.3	0.3	0.3	0.3	0.3	0.3	0.3	0.3
RATED IMPULSE WITHSTAND VOLTAGE (KV)	8	8	8	8	8	8	8	8
POLLUTION DEGREE	III	III	III	III	III	III	III	III

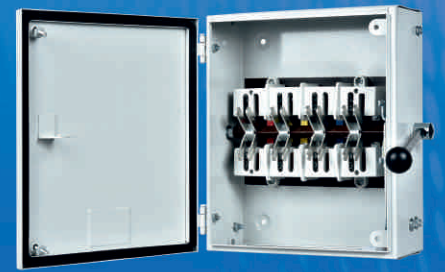

OUR OTHER PRODUCT

TERMINAL BLOCKS POLYAMIDE

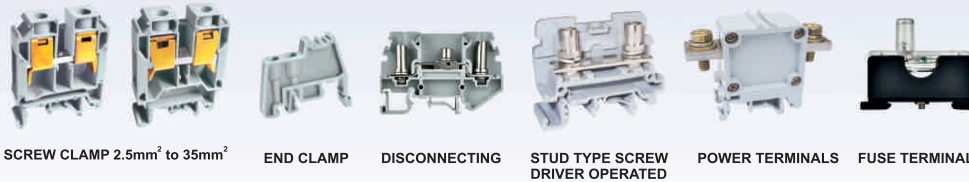

SCREW CLAMP 2.5mm² to 35mm² END CLAMP DISCONNECTING STUD TYPE SCREW DRIVER OPERATED POWER TERMINALS FUSE TERMINAL

TERMINAL BLOCKS MELAMINE

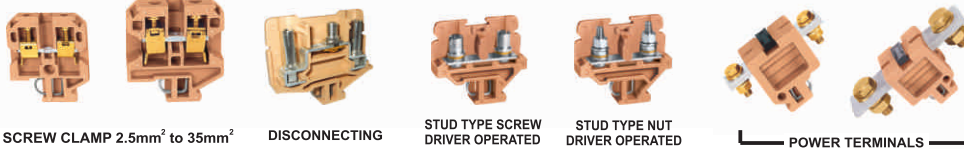

SCREW CLAMP 2.5mm² to 35mm² DISCONNECTING STUD TYPE SCREW DRIVER OPERATED STUD TYPE NUT DRIVER OPERATED POWER TERMINALS

CONTROL & SIGNALING DEVICES



PUSH BUTTON CONTROL STATIONS UPTO 4 WAY

HRC FUSE BASES & LINKS

FUSE PULLER



CYLINDRICAL FUSE LINK TOGGLE SWITCH TERMINAL STRIPS ROTARY SWITCH CURRENT TRANSFORMER AMMETER'S & VOLTMETER'S



METAL CLAD PLUGS & SOCKETS



INDUSTRIAL PLUG & SOCKETS



NEUTRAL LINK 32 AMP. to 400 AMP.



PANEL FAN FILTER & FINGER GUARD



OIL TIGHT LIMIT SWITCH



FOOT SWITCH



REVERSING SWITCH



JUNCTION BOX



ELECTRONIC HOOTER & BUZZER

MANUFACTURED BY

FTC SWITCHGEAR PVT. LTD.

email : ftcindia@gmail.com Website : www.ftcswitchgear.com